

ALPOLIC®/fr MATERIALS

MITSUBISHI PLASTICS COMPOSITES AMERICA, INC.

fr LT – stone & timber

ALPOLIC®/fr LT Stone and Timber aluminum composite material (ACM) panels for interior applications create a world of possibilities, enabling sweeping designs and startling new effects.

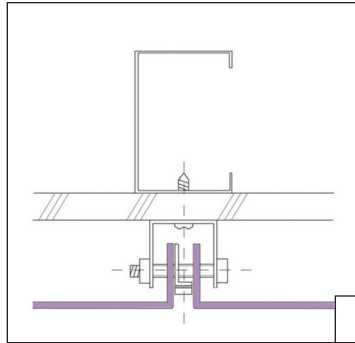

GENERAL INFORMATION

ALPOLIC®/fr LT is the material of the future. This world-class ACM made with thin aluminum skins and a fire resistant core is not only highly durable, it's also extremely lightweight, making it ideal for cladding interior walls, ceilings, columns, and displays.

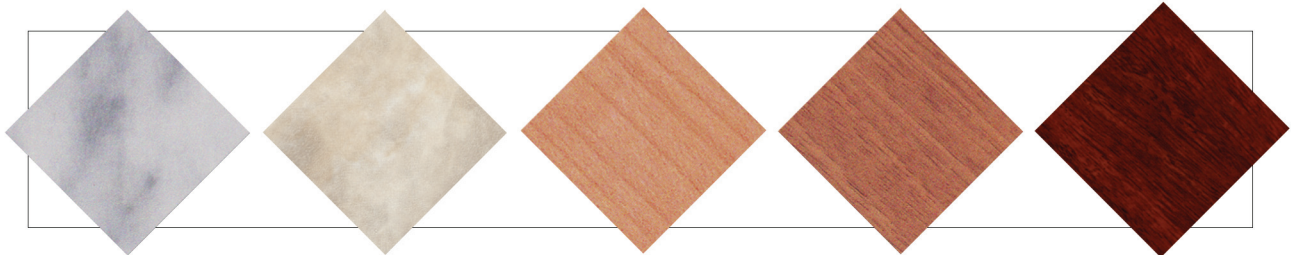

S5 WHITE MARBLE
3-2S5-G90

S6 VENETIAN MARBLE
3-2S6-G90

W1 MAPLE
3-2W1-MATTE

W2 WALNUT
3-2W2-MATTE

W3 MAHOGANY
3-2W3-MATTE

ALPOLIC® /fr LT stone & timber

INTERIOR SURFACING
INTERIOR SIGNAGE

SURFACE TREATMENT

ALPOLIC®/fr LT Stone & Timber finish panels are created through a unique image transfer process and a polyester paint system. Available stock material includes White Marble, Venetian Marble, Maple, Walnut and Mahogany.

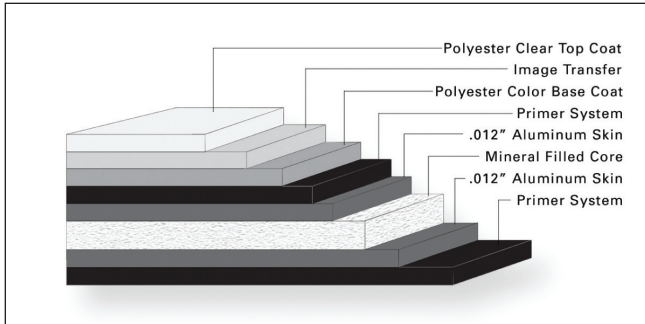

STANDARD PANEL SIZE

Standard stock size is 48" x 96" (1219mm x 2438mm). Panels are stocked in 3mm thickness. Standard crate is 50 pieces. Please contact ALPOLIC® Customer Service for current available stock and additional information.

FINISH TOLERANCE

Color: Visual match to standard
Gloss: Nominal +/- 10 units

PRODUCT TOLERANCE

Width: $\pm 0.08"$ (2mm)
Length: $\pm 0.16"$ (4mm)
Thickness: $4\text{mm} \pm 0.008"$ (0.2mm)
 $6\text{mm} \pm 0.012"$ (0.3mm)
Bow: maximum 0.5% of length and/or width
Squareness: maximum 0.2" (5mm)

ALPOLIC® material is trimmed and squared with cut edges to offer the best panel edge conditions in the industry.

FIRE PERFORMANCE

Fire resistant ALPOLIC®/fr LT Stone & Timber finish panels with a mineral filled core have been tested by independent testing laboratories using nationally recognized tests.

This material meets all requirements of the International Building Code for applications requiring a Class A Fire Rating:

IBC Listed

Please visit www.alpolic-northamerica.com or call technical support for complete report listings and additional information.

WARRANTY

Standard panel warranty: 5 Year
Finish warranty: None
Call ALPOLIC® Customer service for exclusions and warranty details.

PRODUCT NOTES

- Panels should be stored flat in a dry, indoor environment.
- Fabricate panels at temperatures above 55°F.
- Protective film should be removed from panels soon after installation.
- Please refer to ALPOLIC®/fr LT Fabrication Manual for routing and fabrication recommendations.
- Crating fees apply to orders for less than standard piece crate.

FOR TECHNICAL INFORMATION, PLEASE
CALL 1.800.422.7270

U.S. HEADQUARTERS

 MITSUBISHI PLASTICS COMPOSITES AMERICA, INC.

401 Volvo Parkway, Chesapeake, VA 23320

Telephone: 800-422-7270, Facsimile: 757-436-1896

www.alpolic-northamerica.com e-mail: info@alpolic.com